

Diagrams from Daniel Isaac Block, *The Book of Ezekiel, Chapters 25–48* (The New International Commentary on the Old Testament; Grand Rapids, MI: Wm. B. Eerdmans Publishing Co., 1997)

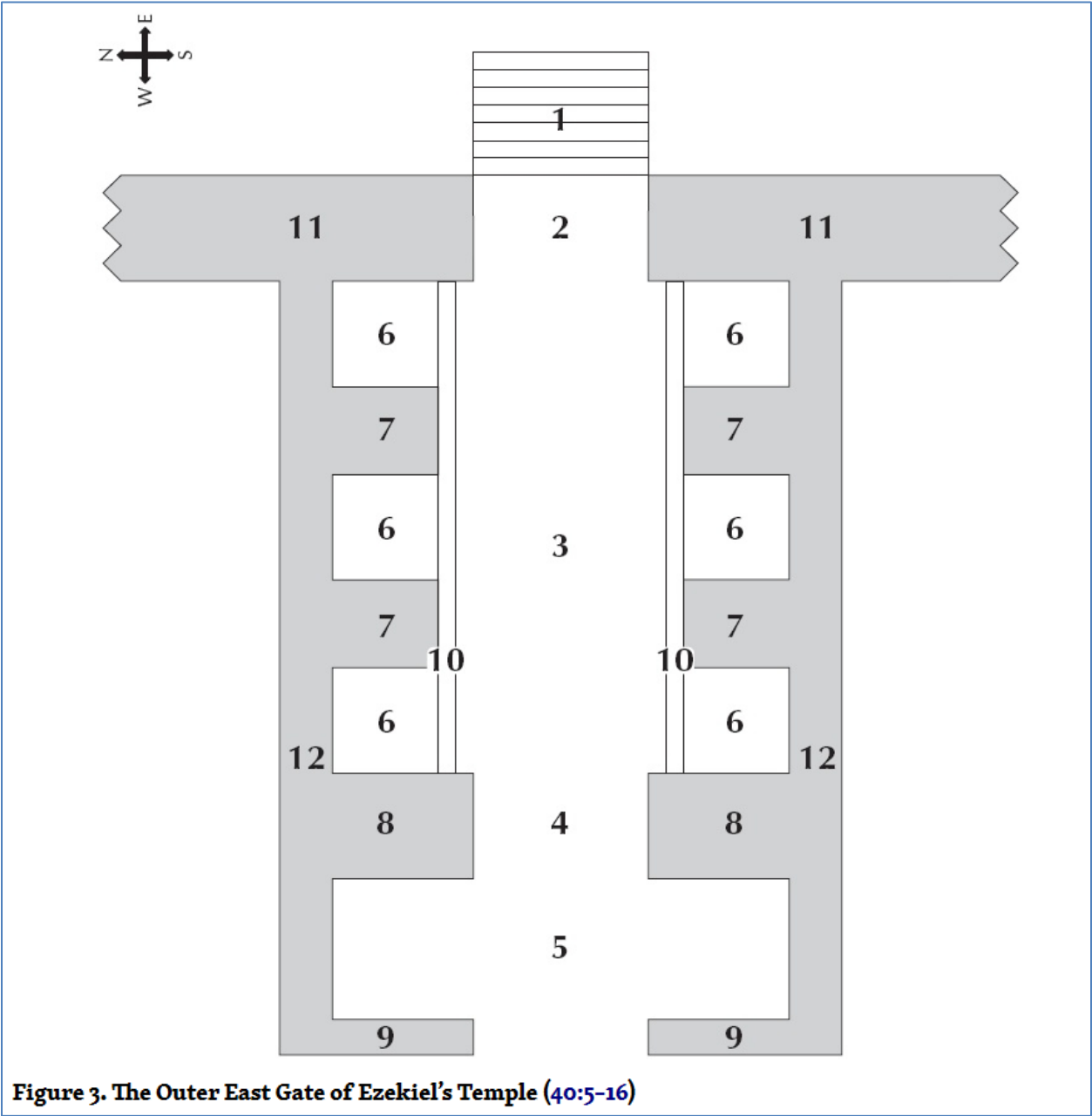

Figure 3. The Outer East Gate of Ezekiel's Temple (40:5-16)

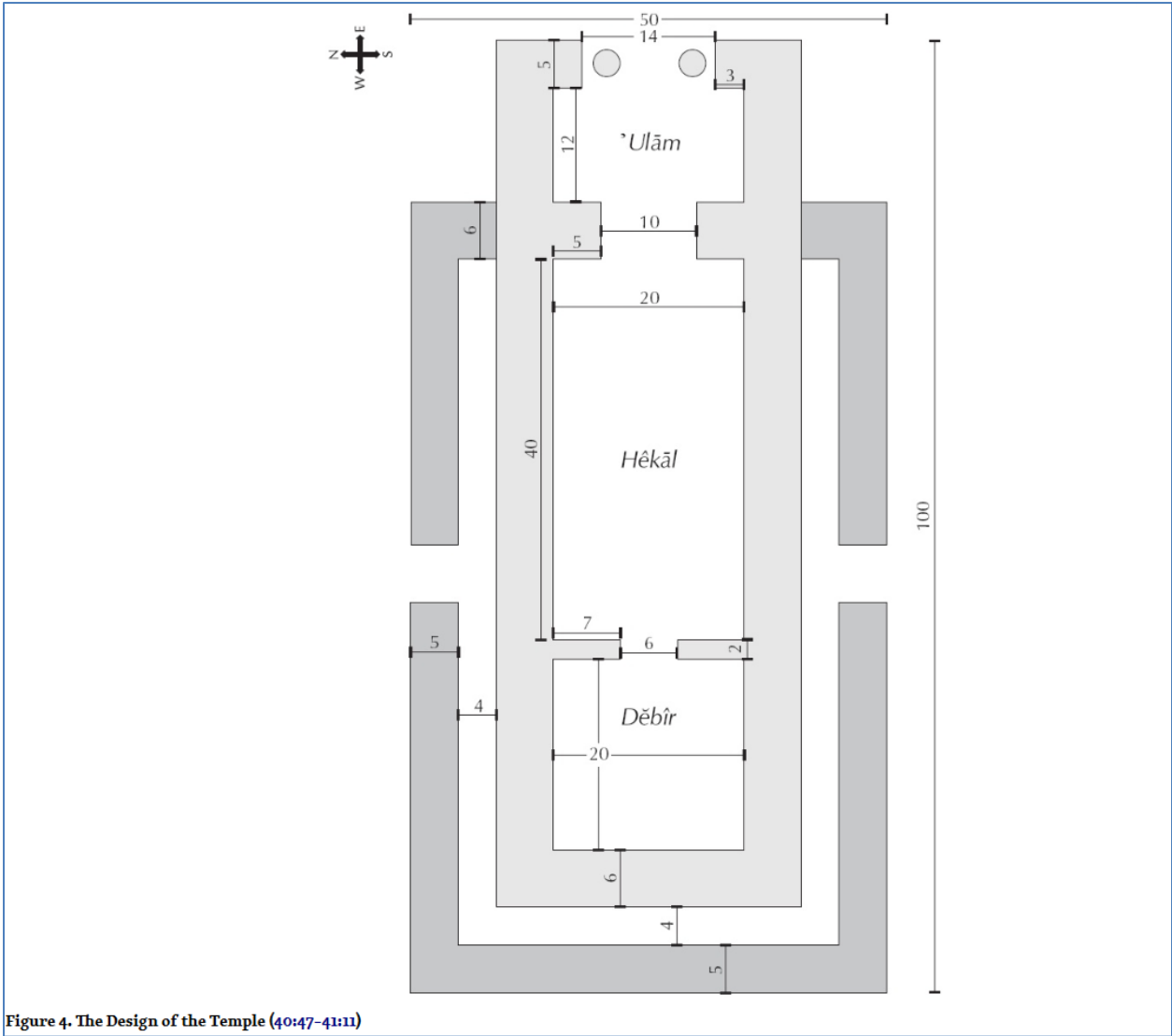

Figure 4. The Design of the Temple (40:47-41:11)

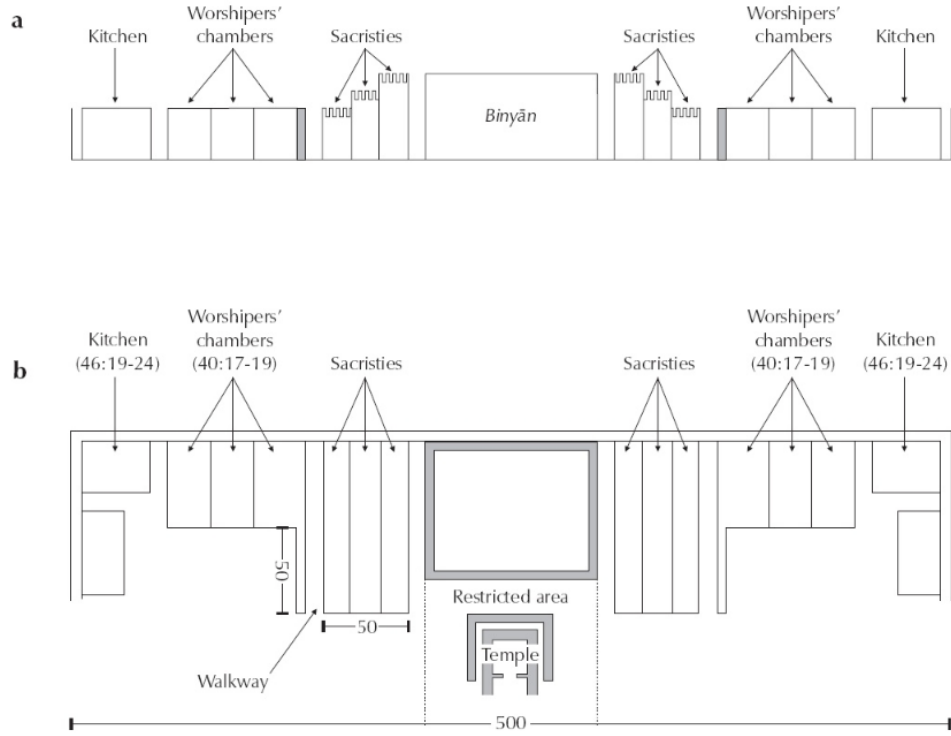

Figure 6. Frontal View (a) and Top View (b) of the West Wall of the Temple Complex (42:1-12)

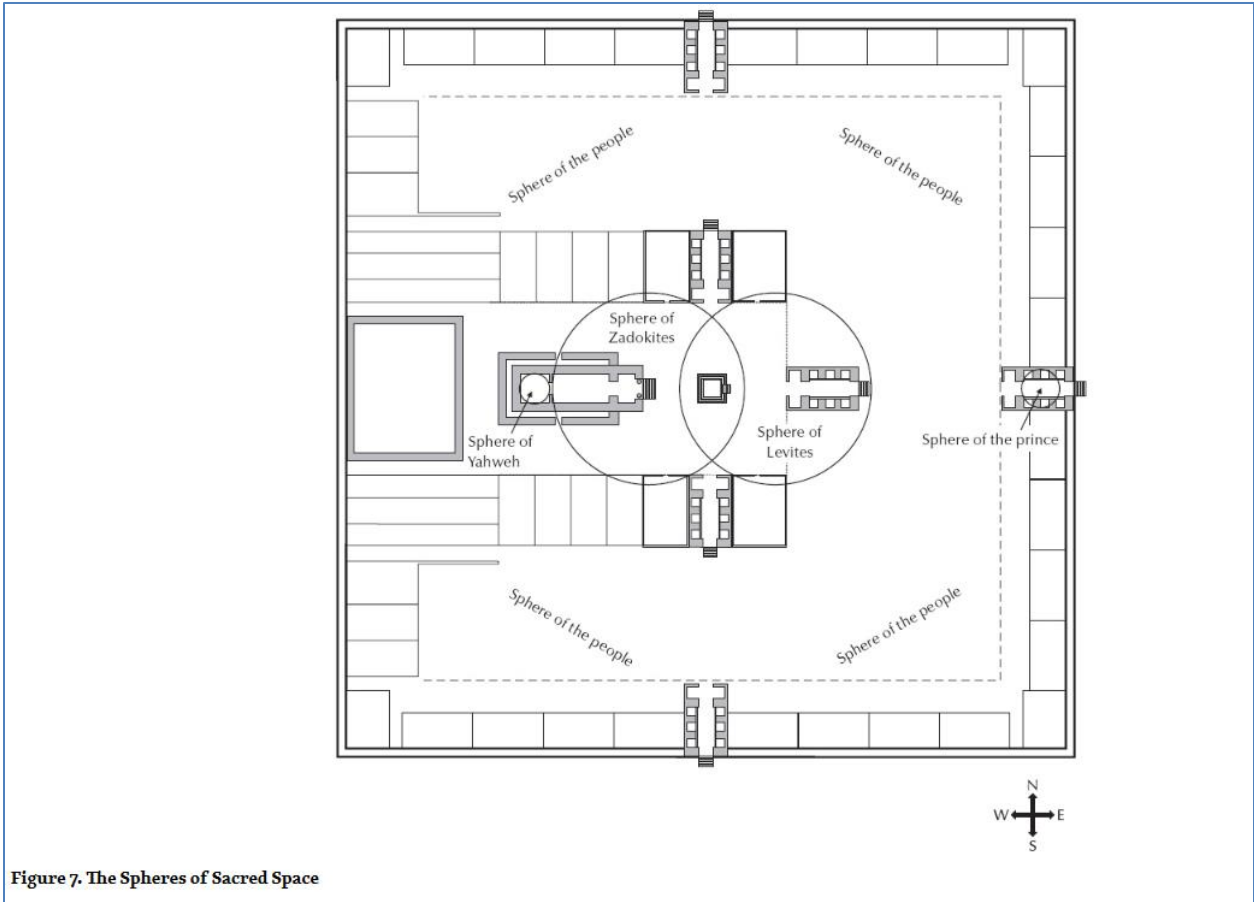

Figure 7. The Spheres of Sacred Space

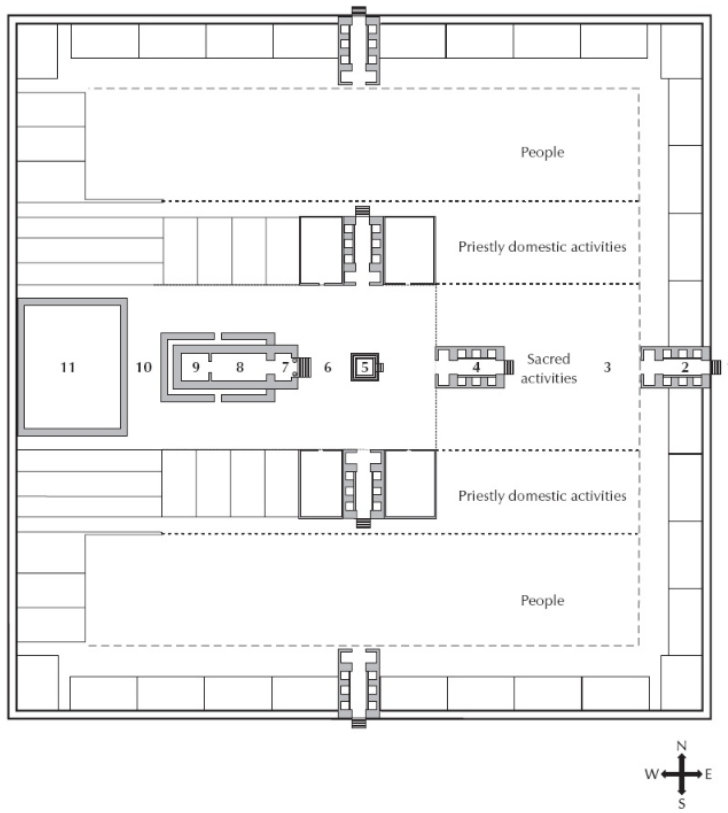
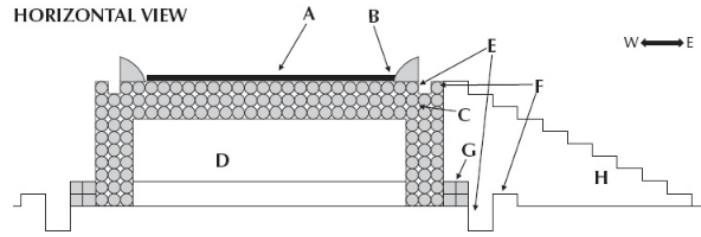

Figure 8. The Spine of Sacred Space



- A Altar surface, plaster (?)
- B Horns (*q̄ērānôt*)
- C Upper wall, uncut stones (*hā'āzārā haggēdōlā*)
- D Inner base, soil
- E Gutter (*hēq*)
- F Curb (*gēbōl*)
- G Lower wall, cut stones (*hā'āzārā hattahtōnā*)
- H Steps (*ma'ālōt*)

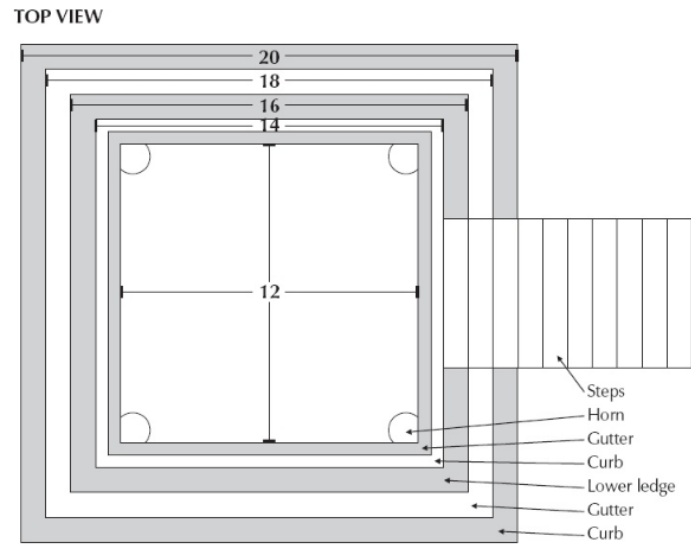

Figure 9. Ezekiel's Altar of Burnt Offerings